

INSTALL PRESET ON LIGHTROOM {DESKTOP}

[CLICK HERE TO WATCH VIDEO TUTORIAL](#)

FIND YOUR LIGHTROOM VERSION

Firstly, it's important to identify the version of Lightroom you're using, as different versions may require different steps. There are a couple of methods to determine your Lightroom version. Just open the Lightroom application on your computer and either:

- Click on 'Lightroom' followed by 'About Lightroom,' or
- Click on 'Help' and then select 'System Info.'

Both approaches will reveal the precise version of Lightroom you're using.

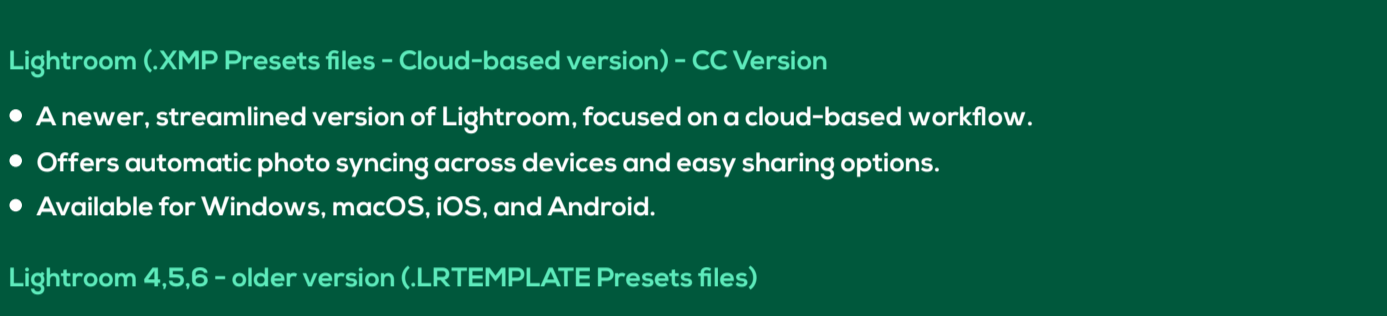

AFTER YOU KNOW YOUR LIGHTROOM VERSION

Lightroom Classic 7.3+ (.XMP Lightroom Preset files on this version)

- The most best version of Lightroom, designed for professional photographers.
- Available for Windows and macOS.

Lightroom (.XMP Presets files - Cloud-based version) - CC Version

- A newer, streamlined version of Lightroom, focused on a cloud-based workflow.
- Offers automatic photo syncing across devices and easy sharing options.
- Available for Windows, macOS, iOS, and Android.

Lightroom 4,5,6 - older version (.LRTEMPLATE Presets files)

- A newer, streamlined version of Lightroom, focused on a cloud-based workflow.
- Offers automatic photo syncing across devices and easy sharing options.
- Available for Windows, macOS, iOS, and Android.

LIGHTROOM CLASSIC 7.3+ (.XMP Files)

- 1.1. Download your Lightroom Presets from PLUGINSO.
- 1.2. The presets will come in a .zip file.
- 1.3. unzipped .zip files.
- 1.4. Navigate to the Develop Module in Lightroom and click on File>Import Develop Profiles and Presets

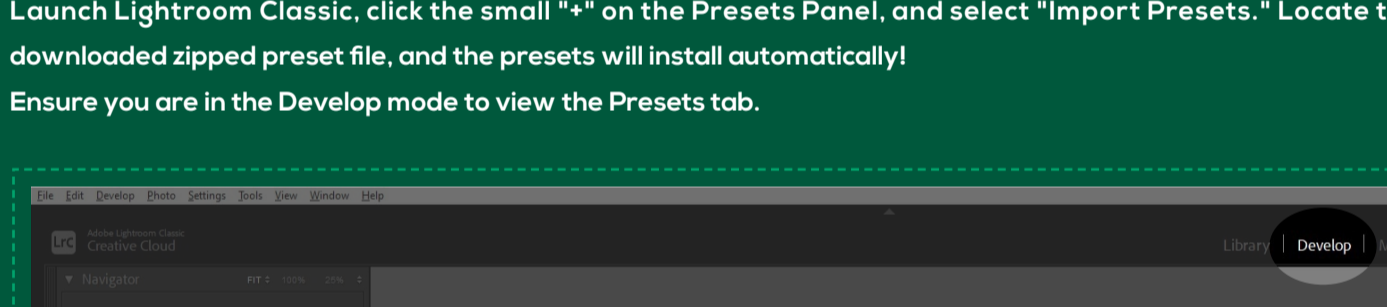

- 1.5. Locate the presets download file, open the unzip file and go to the desktop folder and then the XMP folder.
- 1.6. Open Presets Panel, expand presets folder, and click a preset to apply it.



[CLICK HERE TO WATCH VIDEO TUTORIAL](#)

Lightroom Classic Version 4,5,6 (.LRTEMPLATE Files)

- 1.1. Download your Lightroom Presets from PLUGINSO.
- 1.2. The presets will come in a .zip file.
- 1.3. unzipped .zip files.
- 1.4. OPEN PREFERENCES

Mac: Lightroom > Preferences
Windows: Edit > Preferences.

- 1.5. Choose the Presets tab within the Preferences dialog box, and then:
 - For older versions of Lightroom, click on "Show Lightroom Presets Folder."
 - If you're using a more recent version of Lightroom Classic, click on the "Show All Other Lightroom Presets"

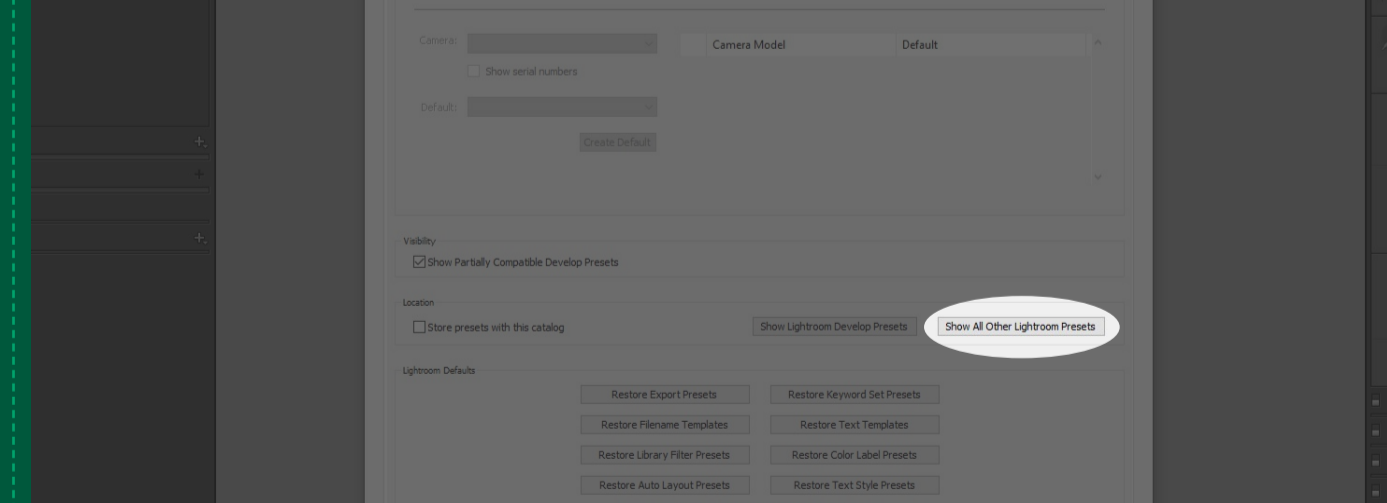

- 1.6. For an OLD Version of Lightroom - Click on Lightroom Folder and then, Open the "Develop Presets" folder.
For a NEW Version of Lightroom - Just Click on the Settings Folder.
- 1.7. Copy the unzipped folder located in your downloads and paste it into the "Develop Presets" folder.
- 1.8. For the final step, restart Lightroom, and you'll discover your presets in the Develop Module, listed under the Presets section.